

# 19TH ANNUAL MOPARS AT JUNCTION



WE'RE BACK FOR  
OUR MONSTER 19<sup>TH</sup>  
ANNUAL SHOW!!

SHOW & SWAP MEET  
Sunday, June 14, 2026  
at Junction Auto Sales

(RAIN DATE: Sunday, June 21st)  
Special Event T-shirt to 1st 200 participants

- Over 300 Participants Annually
- Trophies to Class Winners
- Return of the Burn-Out
- DJ Spinning the Tunes
- Free Food to All Participants
- Special Door Prizes All Day
- Special Feature Showroom Display Cars



Registration 8:00a.m. - 12:00p.m.  
Judging of Entries 12:00p.m. - 2:00p.m.  
FOR SHOW INFORMATION CALL MIKE AT  
(440) 946-5577 • (440) 286-6161  
After Hours (440) 221-2523

## JUNCTION

AUTO SALES, INC.

2006 DEALER OF THE YEAR "Dependability since 1931"

Junction of U.S. 322 & Ohio 44  
P.O. Box 110 Chardon, Ohio 44024  
Phones: (440) 286-6161 • Cleveland (440) 946-5577  
[www.moparsatjunction.com](http://www.moparsatjunction.com)



AUTHORIZED AUTO METAL DIRECT RESTORATION DEALER

CELEBRATING 19 YEARS OF MOPAR SHOW PARTICIPATION!!

# CLASSES

- |   |   |
|---|---|
| #1 AMC<br>#2 Pre-1962 - Original<br>#3 1962-1969 - Original<br>#4 1970-1974 - Original<br>#5 1975-Present - Original<br>#6 Convertible<br>#7 Front Wheel Drive - Original<br>#8 Front Wheel Drive - Custom<br>#9 Pre-1965 - Custom<br>#10 1966-1969 - Custom<br>#11 1970-Present - Custom<br>#12 1962-1969 - Factory Muscle<br>#13 1970-1971 - Factory Muscle | #14 1972-2002 - Factory Muscle<br>#15 2003-Present - Factory Muscle <i>(except Challenger)</i><br>#16 2008-2014 - Challenger Original<br>#17 2015-Present - Challenger Original<br>#18 2008-2014 - Challenger Custom<br>#19 2015-Present - Challenger Custom<br>#20 Original Trucks/Vans<br>#21 Modified Trucks/Vans<br>#22 Best Wing Car / Multi-Carb Cars<br>#23 Survivor<br>#24 Jeep<br>#25 Race Car<br>#26 Best of Show |
|---|---|

| SHOW CARS (PER VEHICLE)                                     | SWAP SPACE                             |
|---|--|
| Day of Show, \$30.00  | 20' X 20' - \$30.00                    |
| Advance (by 6/01/26) \$25.00                                |  |
| (Participant Event T-Shirt Included w/Pre-registered Entry) |  |
| ** XXL & XXXL Add \$5.00                                    | * Must Be Pre-registered Before 6/1/26 |

**FROM CLEVELAND:** TAKE I-90 EAST TO THE ROUTE 44 EXIT. TURN LEFT FOLLOW 44 SOUTH THRU CHARDON SQUARE. CONTINUE SOUTH ON 44 APPROX. 3 MILES ON LEFT.

**FROM THE EAST:** TAKE I-90 WEST TO THE ROUTE 44 EXIT. TURN LEFT FOLLOW 44 SOUTH THRU CHARDON SQUARE. CONTINUE SOUTH ON 44 APPROX. 3 MILES ON LEFT.

**FROM THE SOUTH:** TAKE I-271 NORTH TO THE MAYFIELD RD. EAST (RTE 322) EXIT. TAKE MAYFIELD RD. (RTE 322 EAST APPROX. 14 MILES.

**FROM THE NORTH:** TAKE ROUTE 44 SOUTH THRU CHARDON SQUARE. FOLLOW 44 SOUTH APPROX. 3 MILES ON LEFT.

## JUNCTION

**AUTO SALES, INC.**

2006 DEALER OF THE YEAR "Dependability since 1931"

Junction of U.S. 322 & Ohio 44  
P.O. Box 110 Chardon, Ohio 44024  
Phones: (440) 286-8181 • Cleveland (440) 946-9577



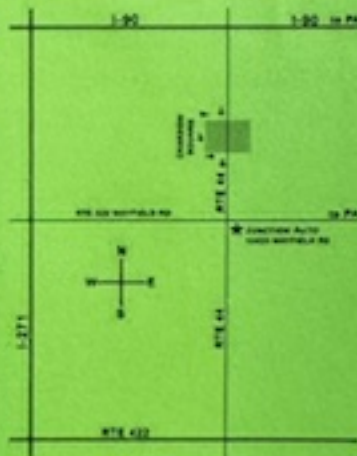

# REGISTRATION

|                            |               |
|----------------------------|---------------|
| <b>NAME / TELEPHONE:</b>   |               |
| <b>ADDRESS:</b>            |               |
| <b>CITY / STATE / ZIP:</b> | <b>EMAIL:</b> |

| CAR YEAR | CAR MAKE | CAR MODEL | CLASS ENTERED | T-SHIRT SIZE |
|----------|----------|-----------|---------------|--------------|
|          |          |           | #             |              |

Make Checks Payable to: Junction Auto